

Duet® Twin Fans

Bathroom/Toilet

Run & Standby Fans



Features & Benefits

- Designed to meet Local Authority run and standby specifications.
- Quiet operation.
- Complies with Building Regulation (Document F) requirements.
- Run and standby facility.
- Self diagnostic check of controls.
- Overrun timer as standard, remote PIR's or humidistat can be installed.

Bathroom ventilation

Duet is a range of run and standby fans designed to provide extraction levels that **comply with Building regulations (Document F)** for bathrooms and toilets and incorporates a run on timer. All models offer automatic changeover on fan failure. Ultra quiet and particularly suitable for areas where unobtrusive sound levels are essential. Duet meets the requirement of Health Technical Memorandum 2025, foul extract ventilation systems 2.8. Ideal for new build and refurbishment installations.

Duet features include LED indicators showing the status of the unit, self diagnostic check of controls before the fan will start, run and standby facility, 5-25 minute run on timer and 24 hour auto fan changeover. Suitable for ambient temperatures of up to +40°C, built-in dust filters.

Double insulated appliance.

Performance

Model	Extract Performance - FID			Sound dB(A) @ 3m	Amps @ 240V
	m³/h	l/s	Watts		
Surface	122	33	35	One fan running 34	0.25
Recessed	122	33	35	One fan running 33	0.25
Duct	122	33	35	One fan running 33	0.25

Supply voltage 220-240V/1/50Hz.

Duet is suitable for use with either 100mm diameter ducting or flat ducting, for installations that need concealed ducting, with a minimal ceiling void of only 90mm required.

Models

Duet Surface

Requires 100mm circular hole in wall. Fan 1/Fan 2 running indicators, fault indicator.

Stock Ref
180510C

Duet Recessed

Flush-mounted model with 100mm discharge spigot. Two flush-mounted washable filter panels, Fan 1/Fan 2 running indicators, fault indicator.

Stock Ref
180610C

Duet Duct

Sheet metal construction. Up to 2 inlets can be connected. 100mm discharge spigots.

Stock Ref
180710C

Remote Indicator

The remote indicator unit provides fan status information at a convenient position.

Stock Ref
180010D

Dual sized spigot

Stock Ref
GTFSF

Dimensions (mm)

	A	B	C	D	EØ	F	G
Surface	347	170	224	69	99	35	
Recessed	385	233	366	255	98	230	35
Duct	366	233	230	36	98		

Duet Surface

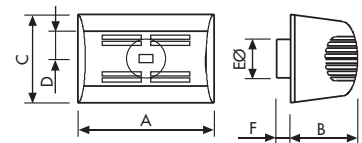

Duet Recessed

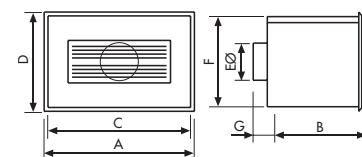

Duet Duct

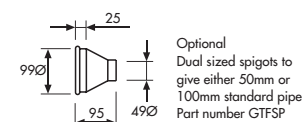
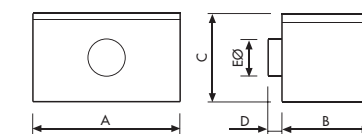

Optional Dual sized spigots to give either 50mm or 100mm standard pipe
Part number GTFSF